

SITE PLAN LEGEND

ECOLOGY NOTES

The installation of a minimum of one bat box on mature trees around the site boundaries will provide additional roosting habitat for bats eg. Viverra Pro Woodstone Bat Box (buildings) Or a similar alternative brand. Bat boxes should be positioned approximately 3m above ground level where they will be sheltered from prevailing wind, rain, and strong sunlight. Small-hole boxes are best placed approximately 1-3m above ground on an area of the tree trunk where foliage will not obscure the entrance hole

The installation of a minimum of one bird box on mature trees around the site boundaries will provide additional nesting habitat for birds eg. Woodstone Nest Box (buildings or trees) Or a similar alternative brand. Tree boxes should be positioned approximately 3m above ground level where they will be sheltered from prevailing wind, rain, and strong sunlight. Small-hole boxes are best placed approximately 1-3m above ground on an area of the tree trunk where foliage will not obscure the entrance hole

Pollution prevention measures should be followed, including PPG5 guidelines, for working near water. Heras fencing with silt netting should be erected along the southern boundary of the site to prevent dust entering the waterway. Machines and tools should be refuelled furthest from the waterbody in a bunded area with spill kits on site



BAT SENSITIVE LIGHTING



Smart lighting controlled with a motion sensor to ensure a dark period between midnight and early morning. All lighting should be low-level and directed down with the use of shields / hoods / covers to prevent light spillage. Lights positioned 1.5m above ground level. LED lighting with directed beam (low leakage), luminaires at a low height, and with warm light LEDs (no UV). Lamp wattage to be 150w (2000 lumens) and below 2700K/evm.

Dark area on site plan should not be illuminated by artificial lighting. Illumination of hedgerows and mature trees should be specifically avoided

All lighting to be in accordance with recommendations by the Bat conservation trust - "Bats and lighting in the UK" and Guidance note 08 / 18 "Bats and Artificial Lighting in the UK".

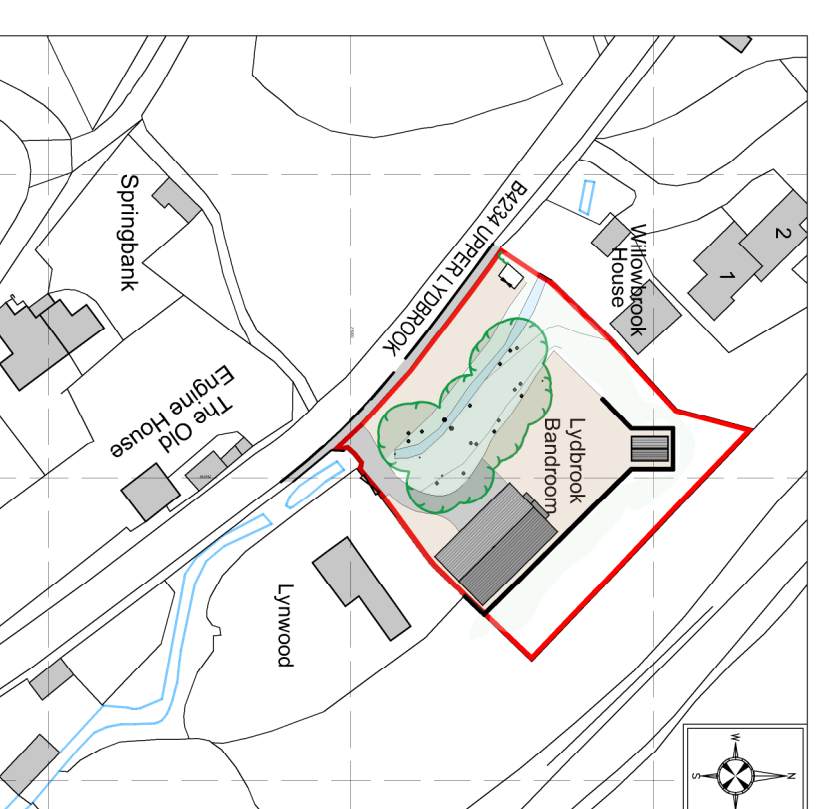
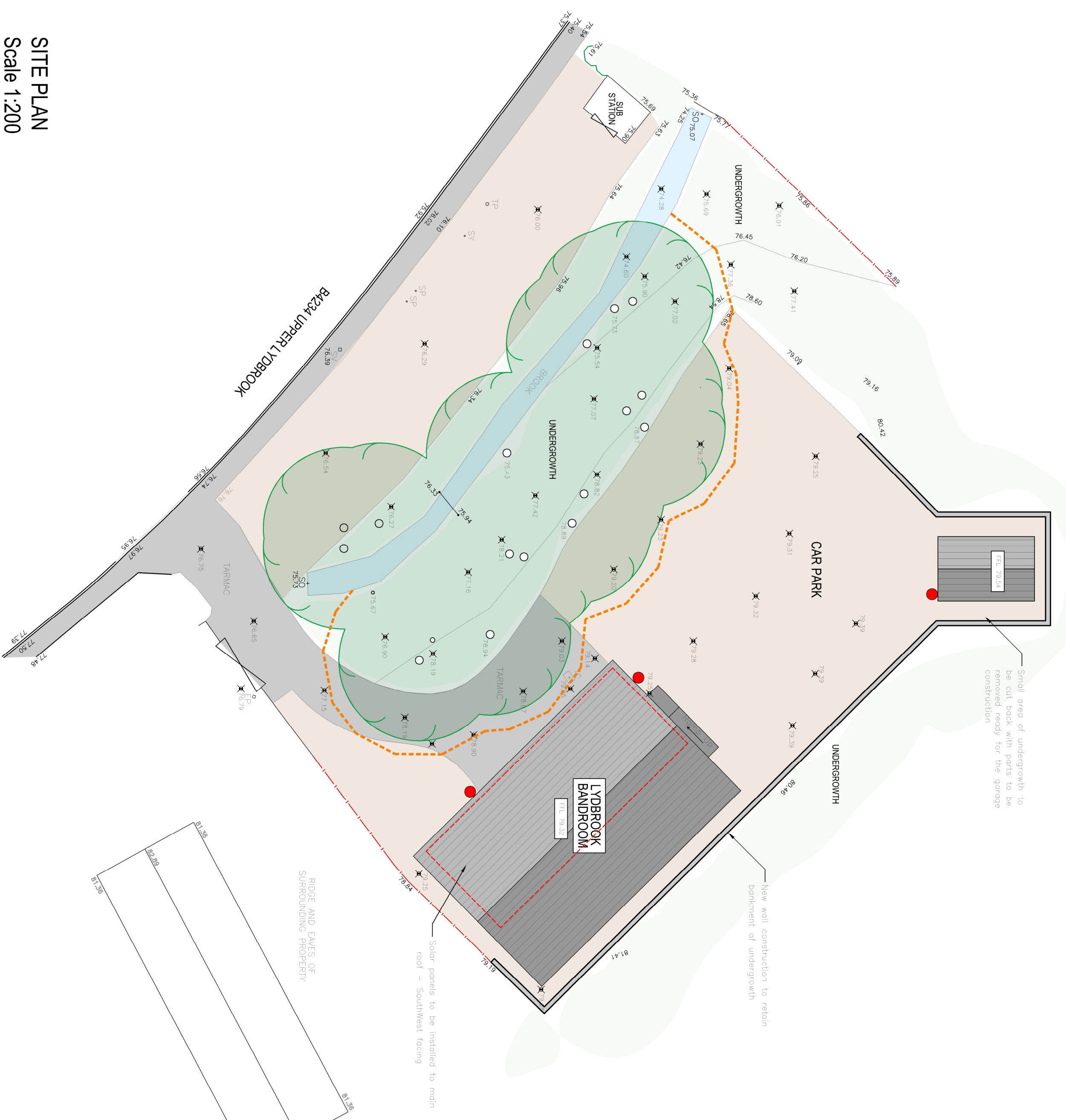

LOCATION PLAN
Scale 1:1250

All dimensions to be checked on site by contractor prior to preparation of shop drawings and commencement of work on site.
Do not scale from this drawing.
This drawing and the copyrights and patents therein are the property of Apex Architecture and may not be used or reproduced without consent.
This drawing is to be read in conjunction with all relevant consultant's drawings/documents and any discrepancies or variations are to be notified to Apex Architecture before the affected work commences.

Revision	Date	Description	Drawn by	Checked by
A	04.07.2023	Scheme revisions	SC	



Oak House, Aylburton, Gloucestershire, GL16 6ST 01594 516161
Washine Business Park, Monmouth, NP25 3SR 01600 800101
The Site, 24 Chisen View Rd, Cheltenham, GL51 9LT 01242 650 980

Client
C/o Robert Morgan

Project
Lydbrook Bandroom
Upper Lydbrook, Lydbrook,
Glos. GL17 9LQ

Title
Proposed Site and Location Plan

Job No.	Drawing No.	Revision
AA7671b	201	A

Scale @ A2 Issue Planning Date May 2023

www.apexarchitectur Ltd com enquire@apexarchitectur Ltd com

SITE PLAN
Scale 1:200